

Lateral Restraint Ties for End Grain Timbers

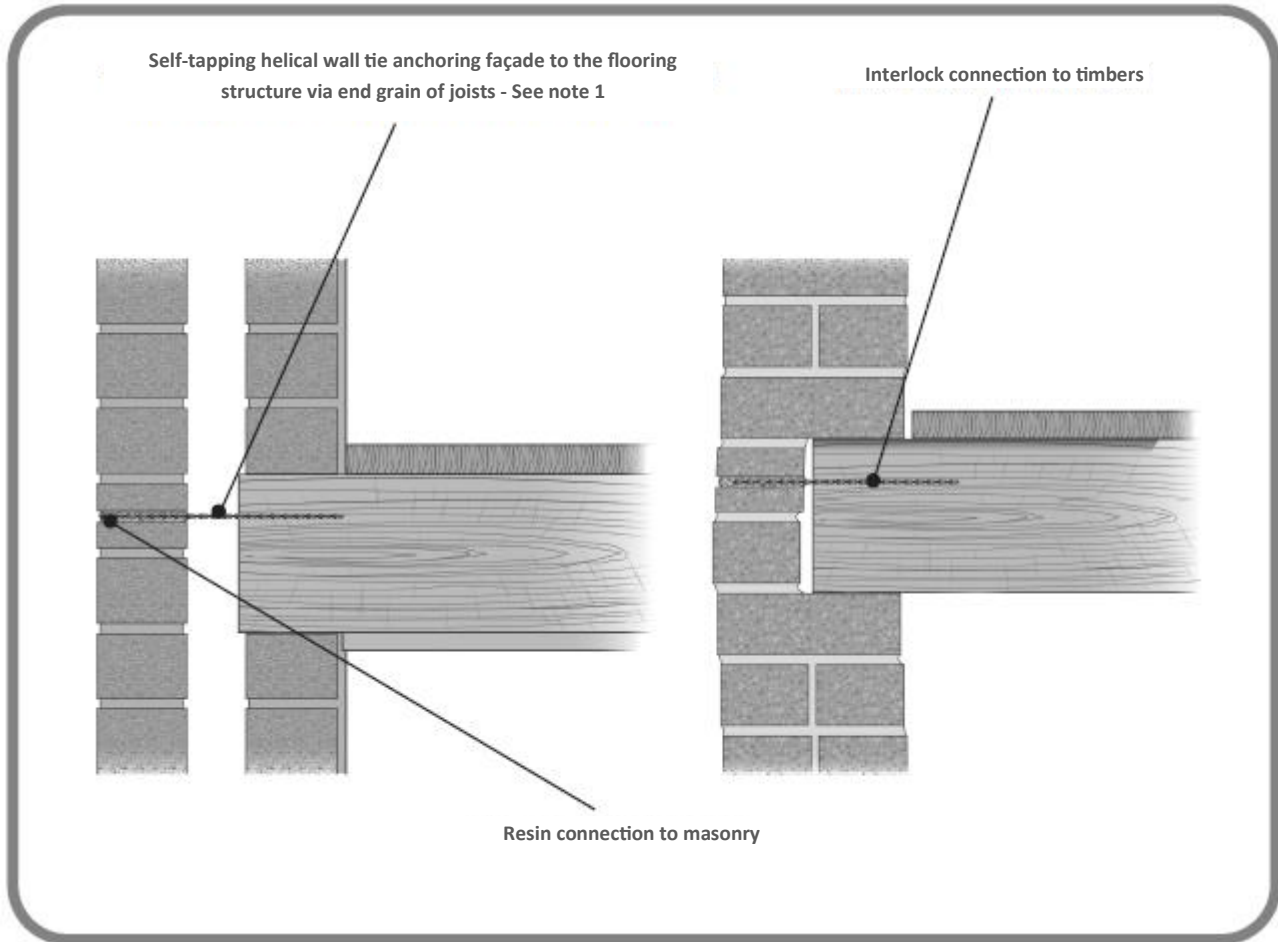

METHOD STATEMENTS & NOTES

1. Drill 12 clearance hole through masonry wall and clear detritus. Hammer-drive self-tapping helical wall ties at least 75mm into sound timber at joist ends. Resin fill hole in masonry to secure the wall tie to the masonry. Make good drill hole to match.

Ties should be installed at each joist end.

TIE ROD SPECIFICATION

- Material: 304 Series Stainless Steel
- Ult. Tensile Strength: 1050-1200N/mm²
- Nominal CSA: 9mm Wall Tie = 14.9mm²

RESIN SPECIFICATION

- Compressive Strength: >56N/mm²
- Tensile Strength: < 10N/mm²
- Flexural Strength: > 16N/mm²
- Elastic Modulus: > 3034N/mm²